

REVISIONS			DATE	APPROVED
ZONE	REV	DESCRIPTION	DATE	APPROVED

## Installation Instructions for UCS 725 Series Rings

- 1) Pour concrete base (3.05m sq.) to within 76.2mm of finished level (~89mm)
- 2) Assemble the two halves of the ring with 4 nuts and bolts (to be specified). Make certain two halves are even and flush with each other
- 3) Center ring on 3.05mx3.05m base, check that it is level, and fasten it down through the 4 holes provided (ram set or other suitable means).
- 4) Clearly mark 19mm down from the rim, all around on the inside of the rim. This will be the level which to float the cement on the inside (Throwing area).
- 5) Pour cement to the marked flush with the rim on the outside of the ring (finished level)
- 6) Allow full cure time for cement

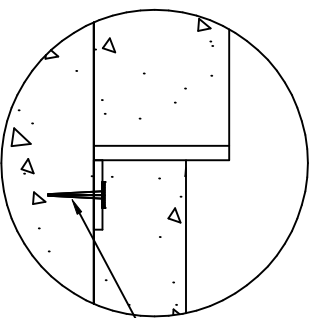

Detail B

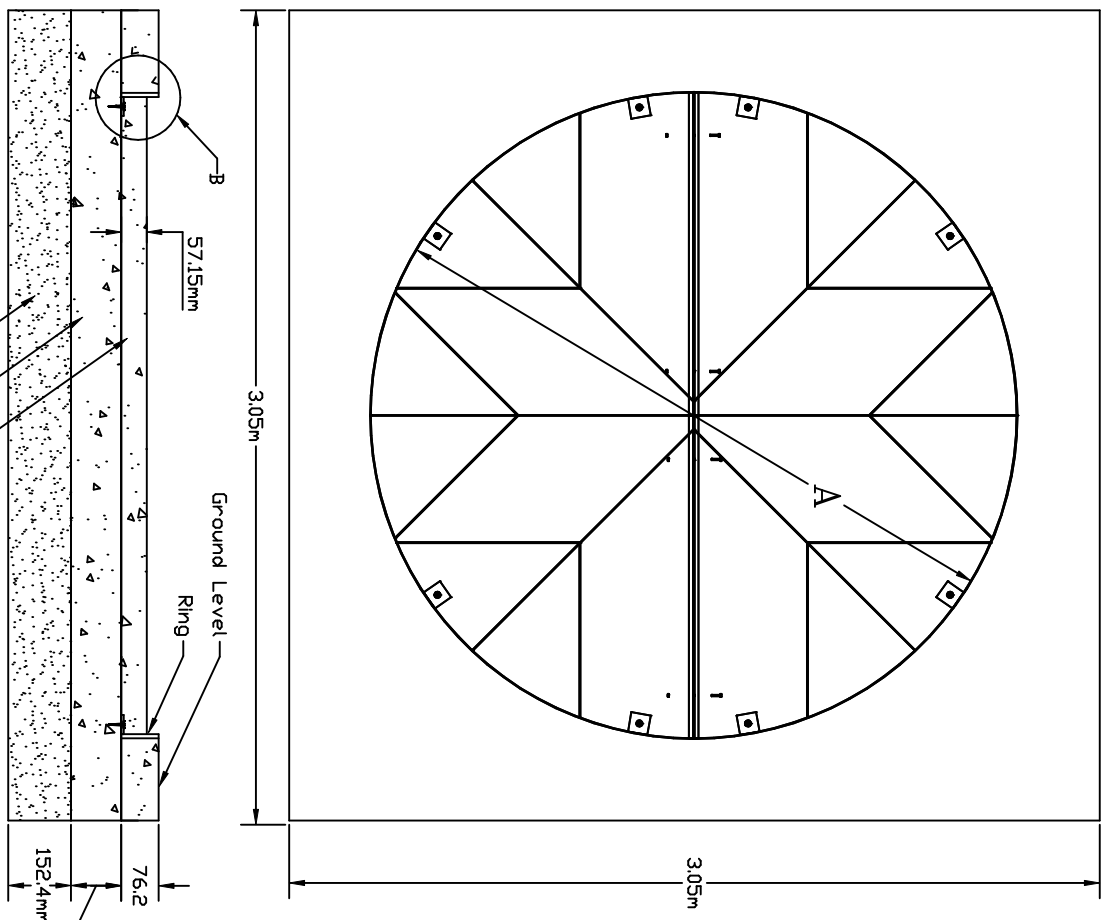

Description		Model	∅[M]
Discus Circle		725-2530	2.500
Shot Put Circle		725-2540	2.135
Hammer Circle		725-2550	2.135

[A] = Inner Diameter

This drawing contains information proprietary to UCS Inc. any reproduction, disclosure or use of this drawing is EXPRESSLY PROHIBITED unless agreed in writing by UCS Inc.

UNLESS OTHERWISE SPECIFIED		CONTRACT NO.		UCS 100 3 RD AVE KEARNY, N.J. 07032	
DIMENSIONS ARE IN INCHES		APPROVALS		TITLE	
DESIRED TOL. ANGLE TOL.		DATE		UCS SERIES 725	
2 PLACES ± 0.2 ± 1/2"		DRAWN: A. ANGLOV/0212/04		RING INSTALLATION	
3 PLACES ± 0.1		CHECKED		SCALE	
WRT.:		ENGINEER		SIZE	
PROTECTIVE FINISH:		CHECKED		FILE	
				DWG NO. 725-Plan-mm.DWG	
				SHEET 1 OF 1	